

cut $23.5 \times 20 \times 2$
 $= 940$
 $4'' \times 2 \times (20 + 23.5)$ sides
 $= 348$
 Total = 1,288

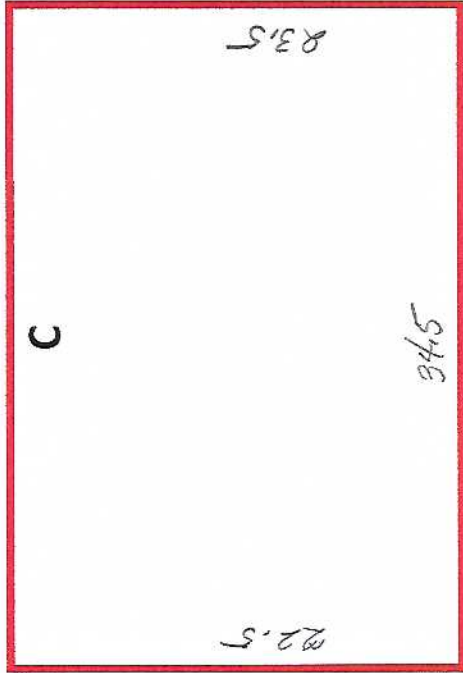

cut $24.5 \times 35.5 \times 2$
 $= 1740$
 $4'' \times 2 \times (23.5 + 35.5)$ sides
 $= 472$
 Total = 2,212

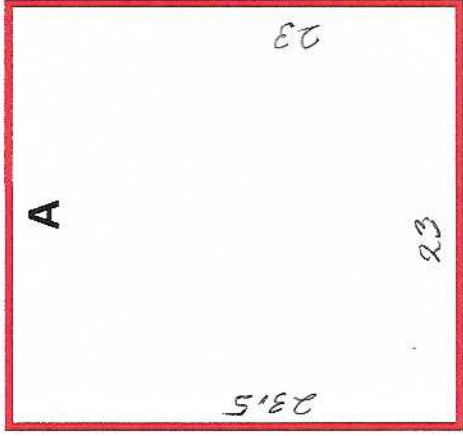

cut 24×24.5
 $= 1176$
 $4'' \times 2 \times (24 + 24.5)$ sides
 $= 388$
 Total = 1,564

Grand Total = 5,064 sq. in.
 1 sq yd of 54" wide
 $= (54'' \times 36'' = 1,944 \text{ sq in.})$
 $5064 / 1944 = 2.6$ yards
 order 5.5 yards?