

# CABIN SOLE SUB FLOOR

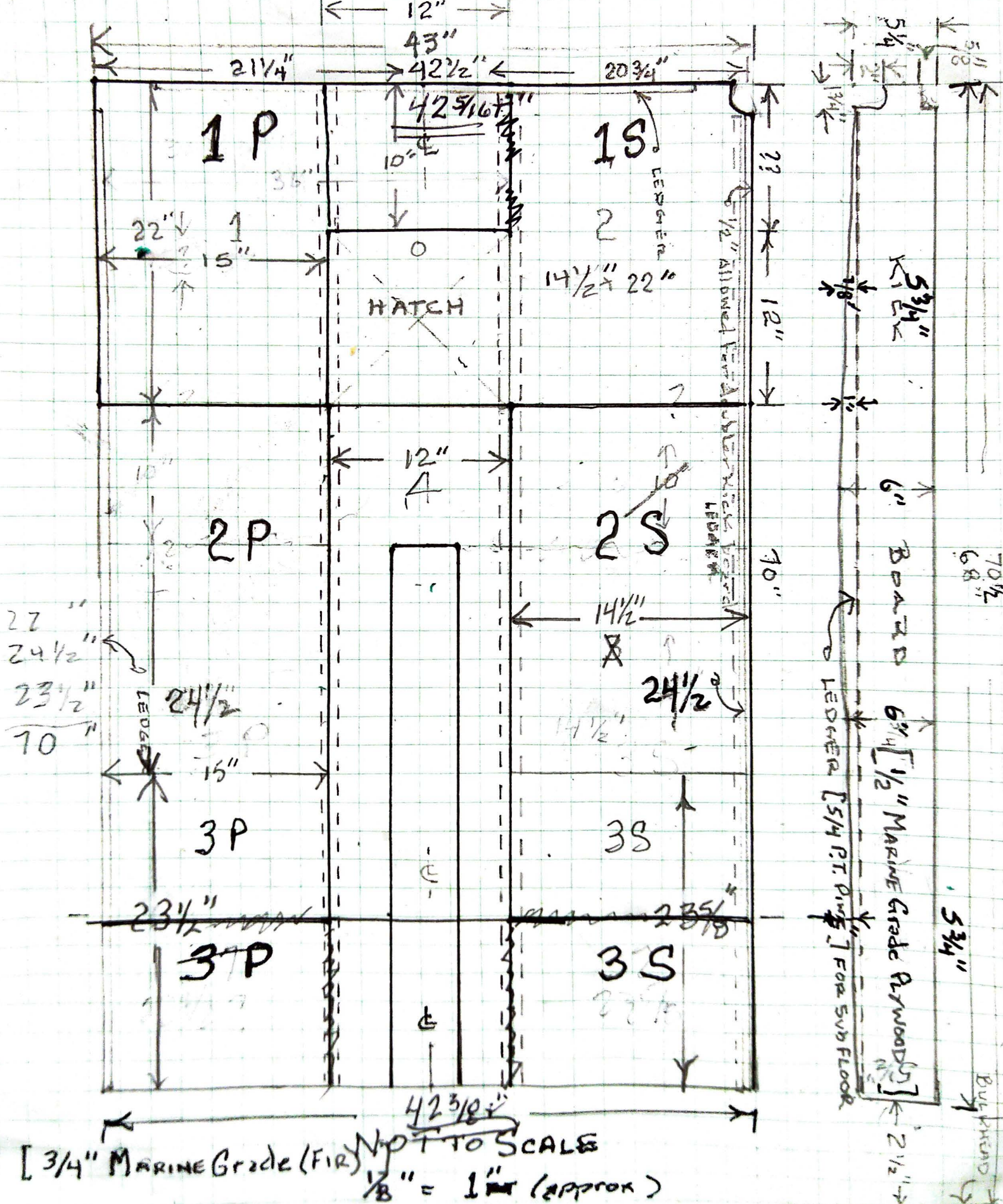

[  $\frac{3}{4}"$  MARINE Grade (FIR) ] NOT TO SCALE  
 $\frac{1}{8}" = 1"$  (approx)

# CABIN SOLE SUB FLOOR

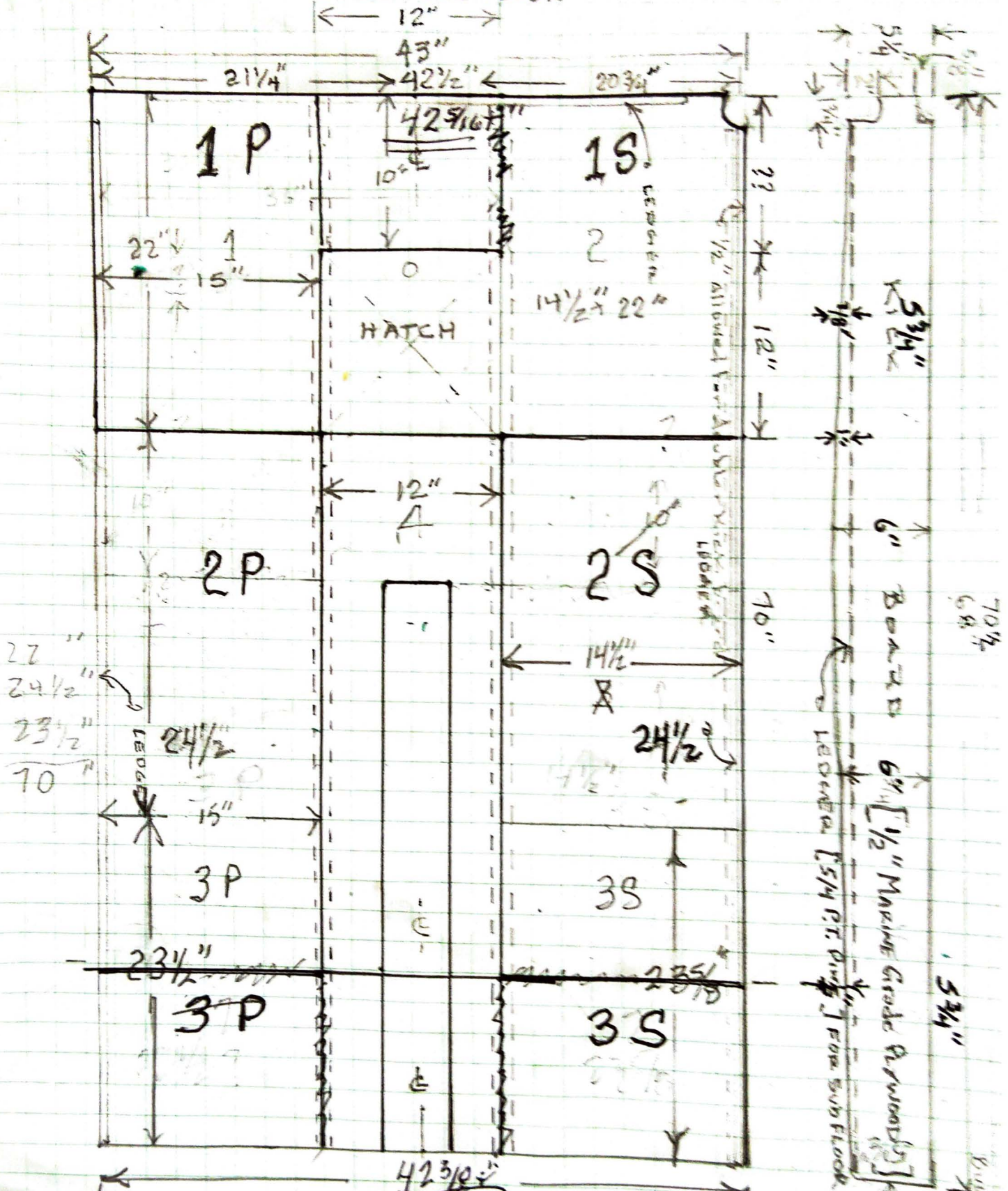

[3/4" MARINE Grade (FIR)] NOT TO SCALE  
 1/8" = 1" (approx)